

306x PIATTO 60X5x150
S275JR - 1:10

84x TUBO 60x4x210
S275JR - 1:10

34x TUBO 60x4x3530
S275JR - 1:10

8x TONDO 12x765
S275JR - 1:10

16x TUBO 60x4x655
S275JR - 1:10

14x PIATTO 60X5x150
S275JR - 1:10

4x TUBO 60x4x890
S275JR - 1:10

4x TUBO 60x4x2485
S275JR - 1:10

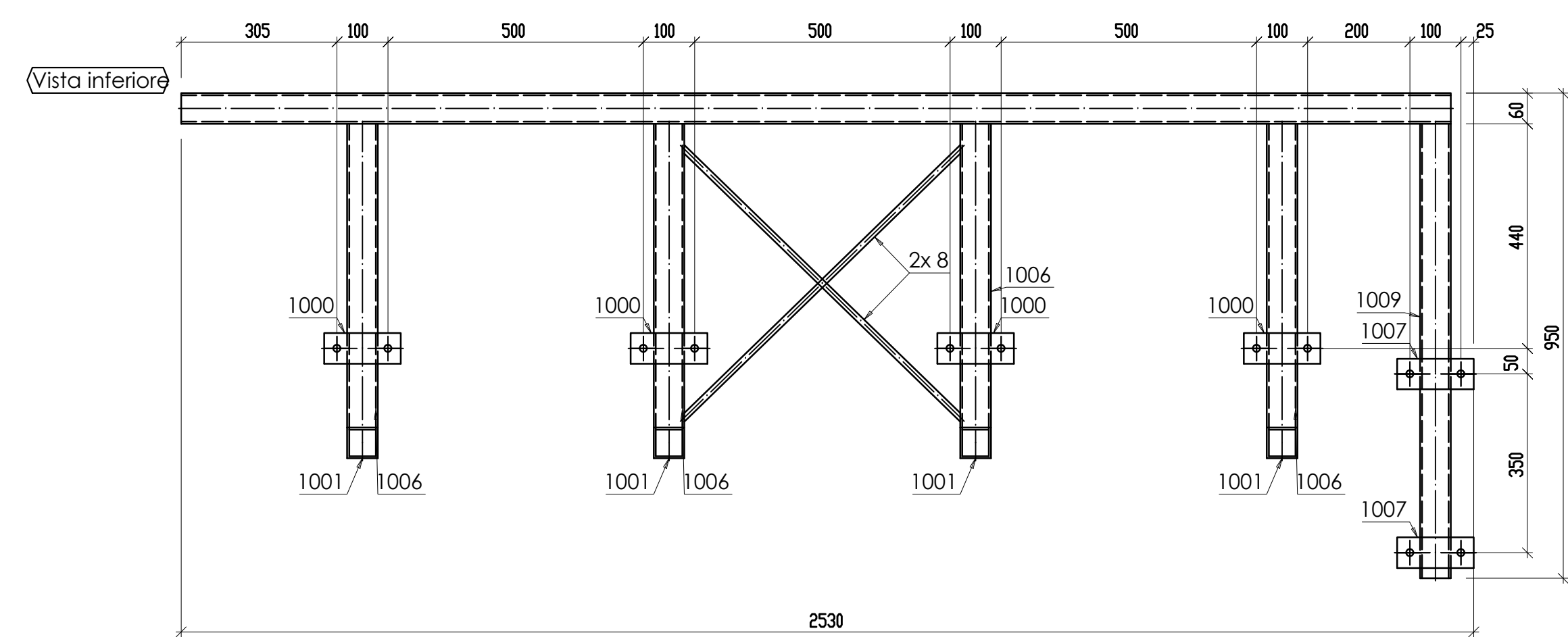

2x TUBO 60x4x2485
S275JR - 1:10

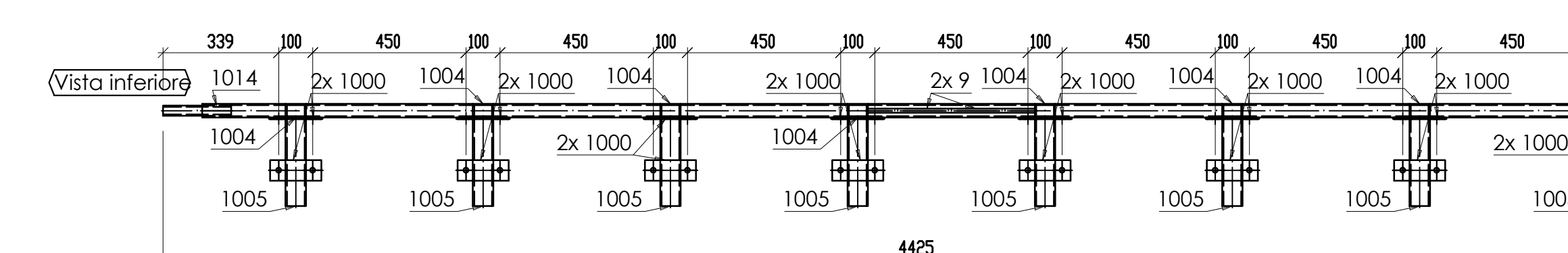
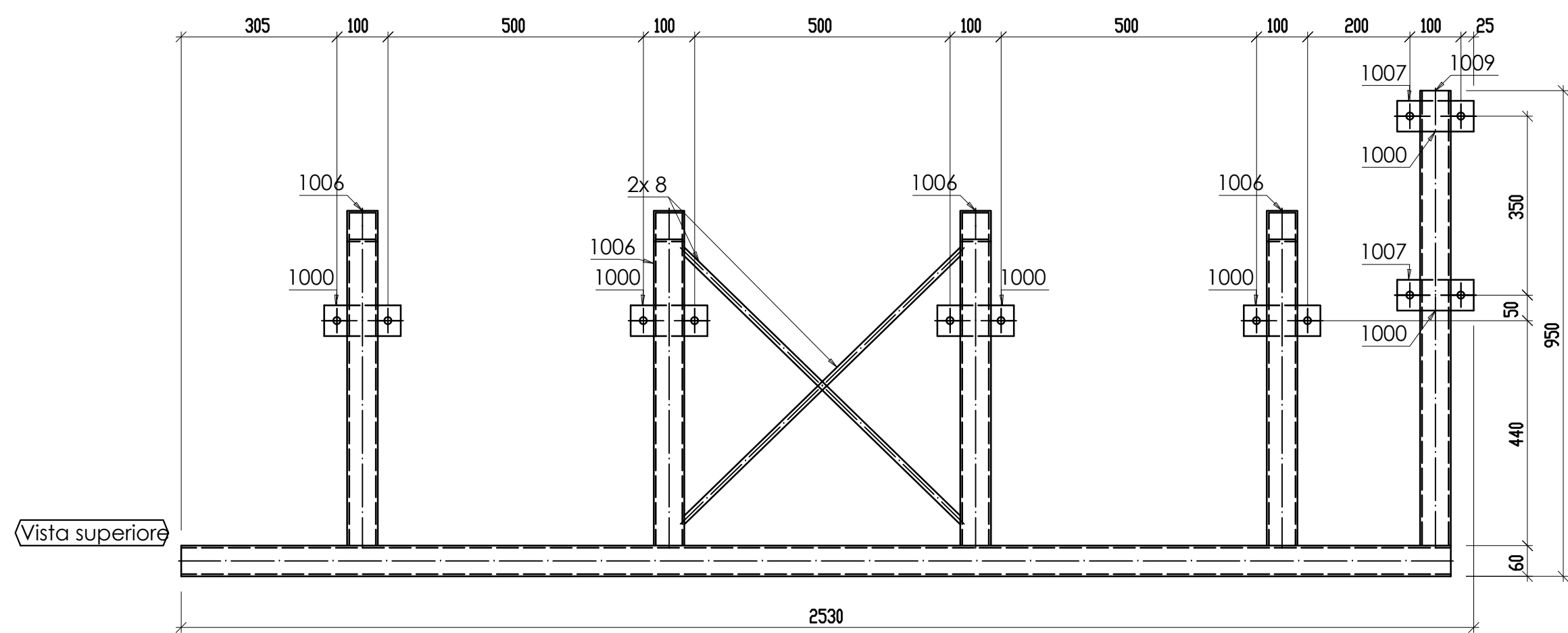
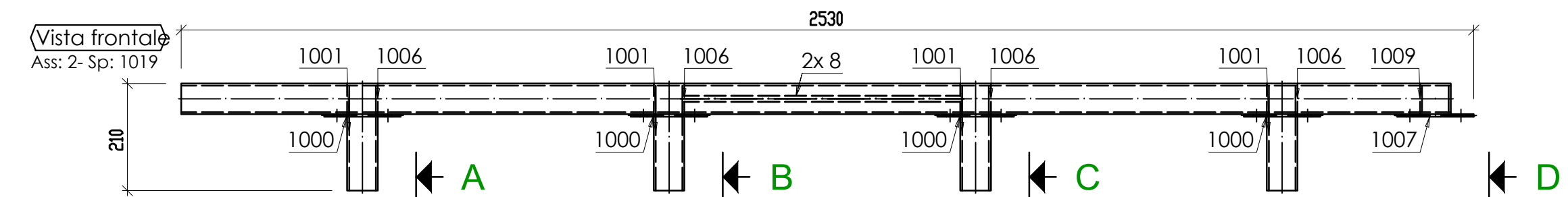

2x TUBO 60x40x4x4225
S275JR - 1:15

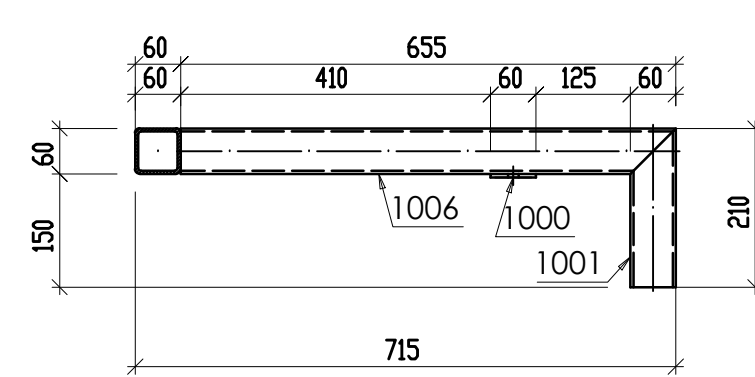
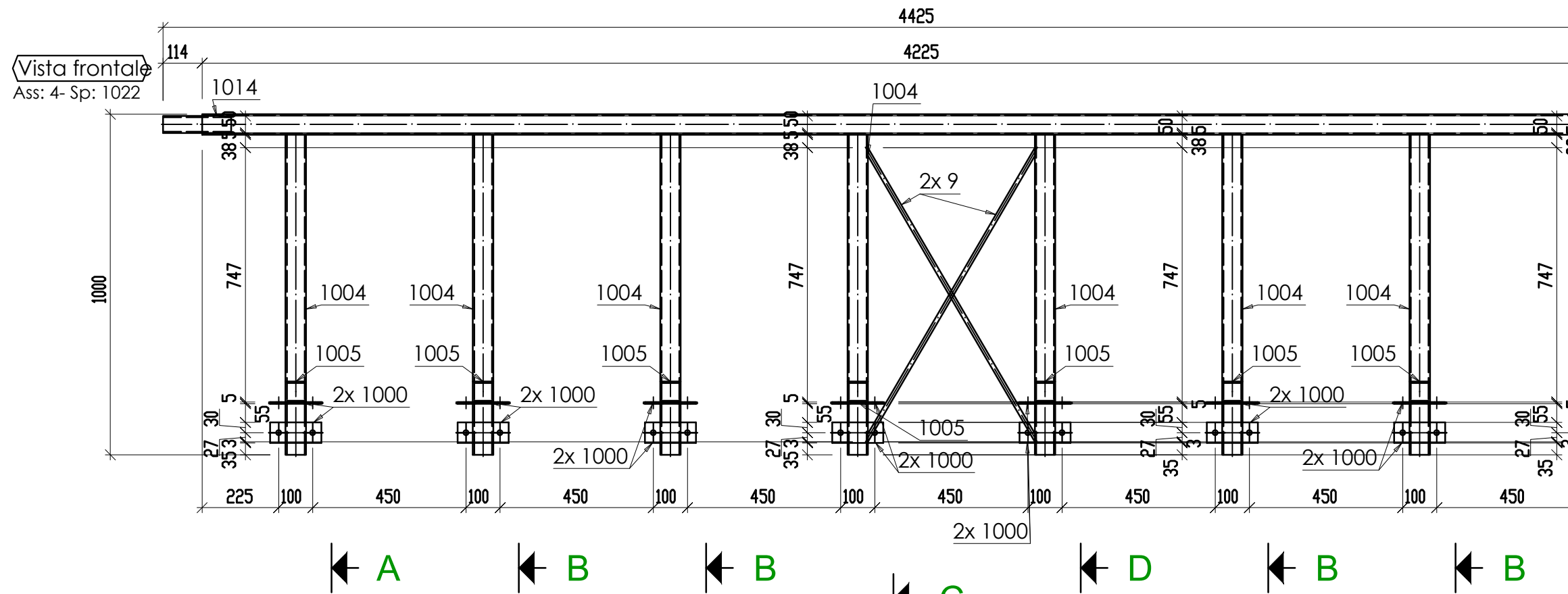

51x TUBO 60x40x4x940
S275JR - 1:10

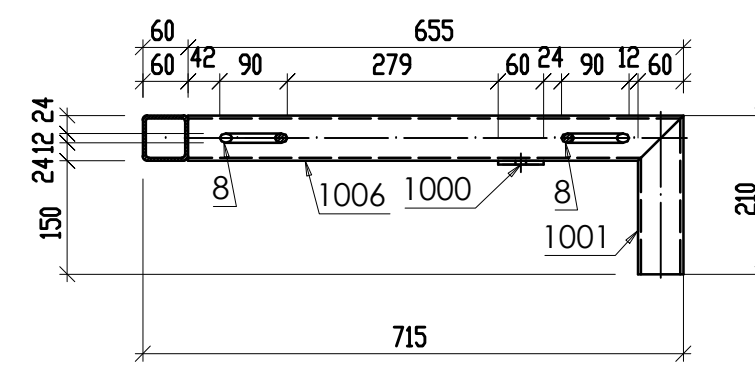

48x TUBO 60x4x260
S275JR - 1:10

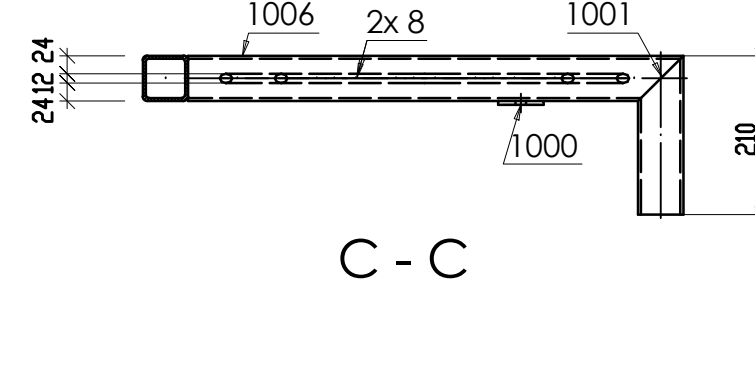

16x TUBO 60x4x655
S275JR - 1:10

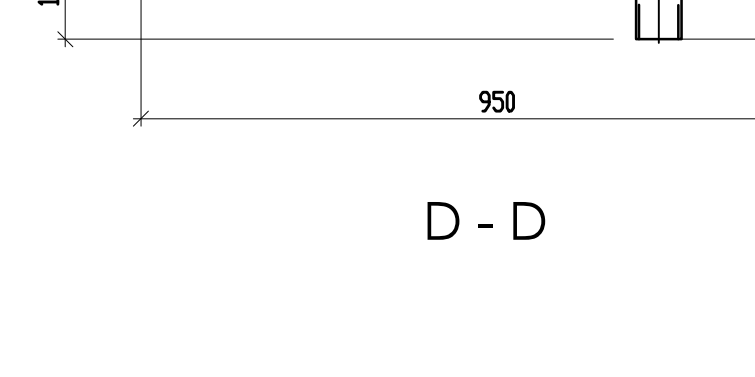

14x PIATTO 60X5x150
S275JR - 1:10



4x TUBO 60x4x890
S275JR - 1:10

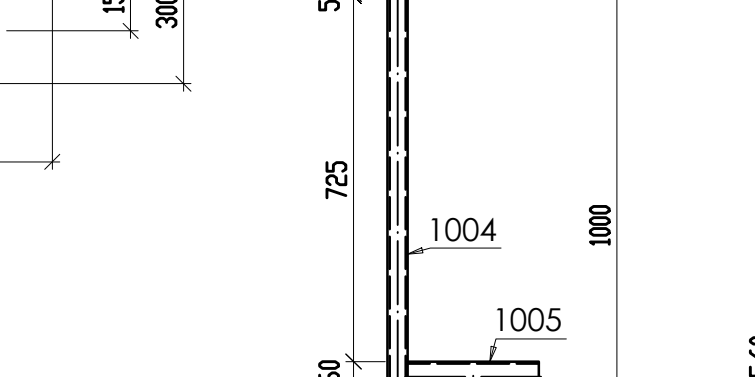

4x TUBO 60x4x2485
S275JR - 1:10

12x TONDO 12x993
S275JR - 1:10

3x TUBO 60x40x4x225
S275JR - 1:10

16x PIATTO 60X5x150
S275JR - 1:10

2x TUBO 60x4x2485
S275JR - 1:10

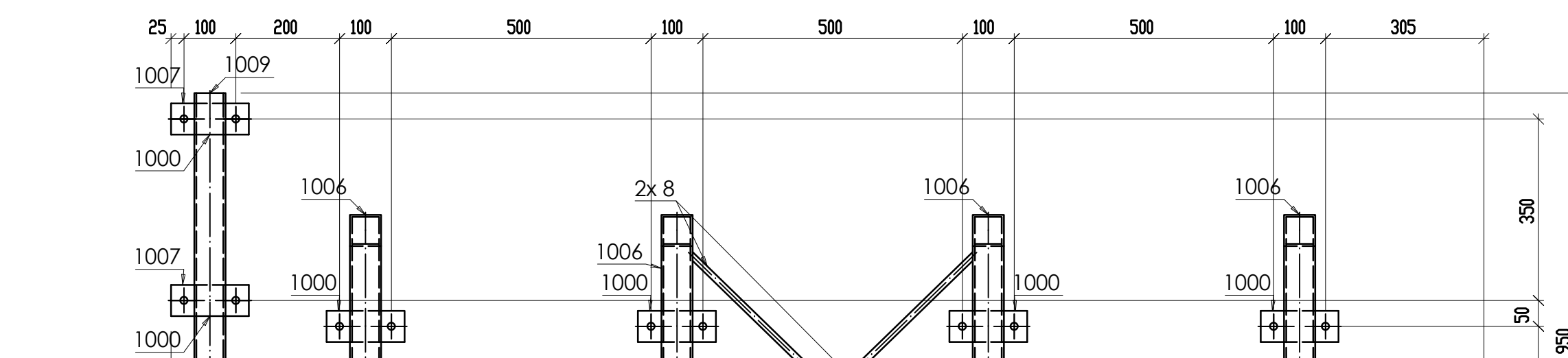
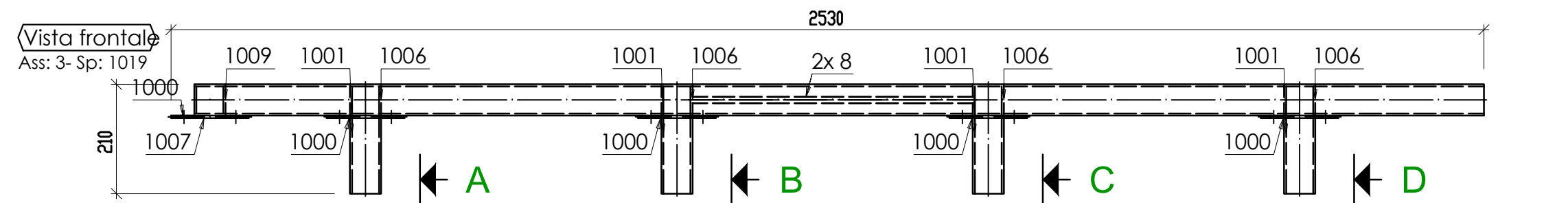

2x TUBO 60x4x2485
S275JR - 1:10

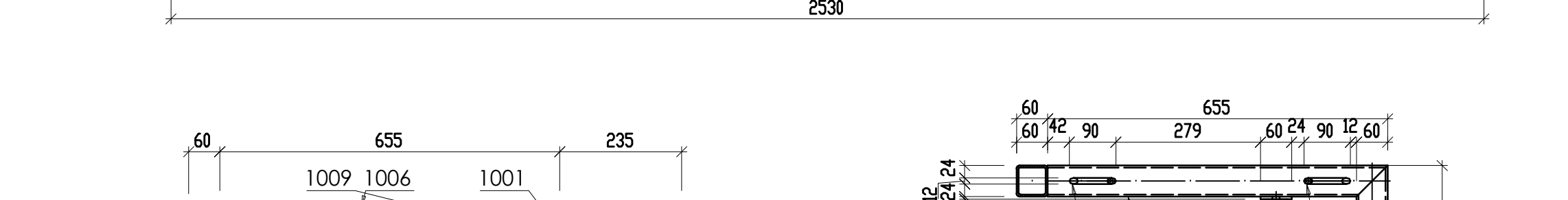

2x TUBO 60x4x2485
S275JR - 1:10

2x TUBO 60x4x2485
S275JR - 1:10

2x TUBO 60x4x2485
S275JR - 1:10

2x TUBO 60x4x2485
S275JR - 1:10

2x TUBO 60x4x2485
S275JR - 1:10

2x TUBO 60x4x2485
S275JR - 1:10

2x TUBO 60x4x2485
S275JR - 1:10

2x TUBO 60x4x2485
S275JR - 1:10

2x TUBO 60x4x2485
S275JR - 1:10

2x TUBO 60x4x2485
S275JR - 1:10

2x TUBO 60x4x2485
S275JR - 1:10

Numero elemento	Q.tà	Nome	Lunghezza (mm)	Larghezza (mm)	Spessore (mm)	Peso (kg)	Peso tot. (kg)	Superficie (mq)	Superficie tot. (mq)
1	30	TUBO 60x4	3530	0	0	24.36	24.36	0.8	0.8
1002	1	TUBO 60x4	210	0	0	1.45	2.9	0	0.1
1001	2	TUBO 60x4	210	0	0	1.45	2.9	0	0.1
1000	4	PIATTO 60x5	150	0	0	0.35	1.41	0	0.1
Totale							29.67	0	1
2	2	TUBO 60x4	2485	0	0	17.15	17.15	0.6	0.6
1019	1	TUBO 60x4	890	0	0	6.14	6.14	0.2	0.2
8	2	TONDO 12	765	0	0	0.68	1.36	0	0.1
1006	4	TUBO 60x4	655	0	0	4.52	18.08	0.2	0.6
1001	4	TUBO 60x4	210	0	0	1.45	5.8	0	0.2
1000	6	PIATTO 60x5	150	0	0	0.35	2.12	0	0.1
1007	2	PIATTO 60x5	150	0	0	0.35	0.71	0	0
Totale							51.35	0	1.8
3	2	TUBO 60x4	2485	0	0	17.15	17.15	0.6	0.6
1019	1	TUBO 60x4	890	0	0	6.14	6.14	0.2	0.2
8	2	TONDO 12	765	0	0	0.68	1.36	0	0.1
1006	4	TUBO 60x4	655	0	0	4.52	18.08	0.2	0.6
1001	4	TUBO 60x4	210	0	0	1.45	5.8	0	0.2
1000	6	PIATTO 60x5	150	0	0	0.35	2.12	0	0.1
1007	2	PIATTO 60x5	150	0	0	0.35	0.71	0	0
Totale							51.35	0	1.8
4	2	TUBO 60x40x4	4225	0	0	23.03	23.03	0.8	0.8
1022	1	TUBO 60x40x4	940	0	0	0.88	1.76	0	0.1
8	2	TONDO 12	765	0	0	0.68	1.36	0	0.1
1006	4	TUBO 60x4	655	0	0	4.52	18.08	0.2	0.6
1001	4	TUBO 60x4	210	0	0	1.45	5.8	0	0.2
1000	6	PIATTO 60x5	150	0	0	0.35	2.12	0	0.1
1007	2	PIATTO 60x5	150	0	0	0.35	0.71	0	0
Totale							87.13	0	3.1



COMUNE DI VANZAGO

PROGETTAZIONE IMPIANTI ELETTRICI
PERITO INDUSTRIALE **DANIELE CERRI**
iscritto all'ordine dei Periti Industriali e
Periti Industriali Laureati delle province di Milano e Lodi
n° 3924

PROGETTAZIONE STRUTTURE
MADE s.r.l., Via della Pusterla, 9 - 27100 Pavia
PROGETTISTA STRUTTURALE
INGEGNERE **GABRIELE PORTA**
iscritto all'ordine degli Ingegneri della provincia di
Milano
n° A25859

PROGETTAZIONE ARCHITETTONICA
E COORDINAMENTO GENERALE
BZZ
ARCHITETTO **SABINO BIZZOCA**
iscritto all'ordine degli Architetti
di Milano
n° 17700
www.bzz-oc.com

AMPLIAMENTO
CIMITERO COMUNALE

PROGETTO ESECUTIVO

Carpenteria metallica
Assieme 1 di 5

TAV. N° **ST-08**
SCALA 1:20/10
DATA MAGGIO 2025